



Stock Fauxwood Blinds

2025 Product Info & Price Guide

CONTENTS

Order & Service Information..... 3

Manufacturer Warranty..... 4

Product Structure..... 5

Components Reference..... 6

Care Instructions & Product Standards..... 7

Product Options, Dimensions & Installation Guide..... 8

Mounting Hardware Quantity..... 9

Wholesale Price Chart..... 9

Measuring Guide for Inside & Outside Mounts.....10

Contract Quote Options & Ordering Terms.....11

ORDER & SERVICE INFORMATION

HOW TO SUBMIT YOUR ORDERS

Email Orders: orders@blindscalifornia.com

Phone Orders: 909-660-6000

LEAD TIME

Blinds California ships orders within 5 business days. Orders placed after 2:00 PM pacific time are considered as the next day business.

Contract orders (25 pieces and more) lead time is confirmed after order is finalized.

ORDER ACKNOWLEDGEMENT

Order Acknowledgement (OA) / Estimate is sent via email within 48 hours (2 business days) of receiving orders.

In cases where order processing exceeds 48 hours due to special circumstances, the lead time will still be calculated based on the original order date. Please make sure you have your updated email address on file with us.

The order will NOT be processed unless the Order Acknowledgement / Estimate is confirmed. Delayed confirmation may result in a postponement of the order's completion.

CANCELLATION OR CHANGE ORDERS

We can not accept changes or cancellations after orders have been processed.

RUSH CHARGE

Rush order option is available.

\$24/pc for 2 days rush. \$12/pc for 3 days rush.

PRICE/ QUOTATION

The price is subject to change without notice.

Local sales tax will be added to the total price if no seller's permit is provided.

PAYMENT TERM

Payment term is subject to credit review. We have the right to hold the order and shipment if outstanding balance is overdue. Credit card payment is subject to 3.5% processing fee.

WILL CALL POLICY

Will call pickup is available. Please call in advance to confirm the product availability and readiness. Will call hours are Monday to Friday, 9:00 AM - 12:30 PM, 1:30 PM-4:00 PM pacific time (except holidays).

Full payment is required upon pickup.

FREIGHT DAMAGE AND SHORTAGES

Please inspect all shipments immediately and carefully.

Please report the damages and shortages on the delivery receipt to Blinds California's customer service within 24 hours. No freight damage claim will be accepted after 5 days from the delivery date.

RETURN AND RESTOCK

All return stock is subject to 20% restocking fee. Customers need to handle the return shipping cost.

All return products needs to be in original package and sellable condition.

Credit will be issued after return inspection to confirm the product quantity and condition.

No return is accepted for customized size.

MANUFACTURER WARRANTY

1-YEAR LIMITED MANUFACTURER WARRANTY

WHAT IS COVERED BY THE WARRANTY

- Warranty is offered to the original owner.
- The warranty only applies to products installed properly in the window for where they were intended, following the installation instructions, care guide, and suggestions.
- The warranty applies to products made and assembled solely with our original materials.
- Warranty will repair or replace the product solely at the manufacturer's option due to defective material or poor workmanship.

WHAT IS NOT COVERED BY THE WARRANTY

- This warranty does not apply to any products damaged by accident, misuse, abuse, direct exposure to salty air or improper moisture, discoloration due to sunlight, under exposure or irregular temperature.
- This warranty does not apply to conditions caused by normal wear and tear upon the product. It does not apply to any product damaged by fire, flood, wind, rain, lightning, or other act of nature environment.
- In no event shall the manufacturer be liable for incidental or consequential damage, loss, cost, expense or fee.
- Warranty does not apply to liquidated or discontinued items.
- Warranty does not include shipping charges.

INFORMATION NEEDED FOR WARRANTY CLAIM

Please contact the customer service with the following information, including:

- Original sales order with invoice number and side mark
- Specific product (line number in the confirmed OA)
- Detailed description of defect

PRODUCT STRUCTURE

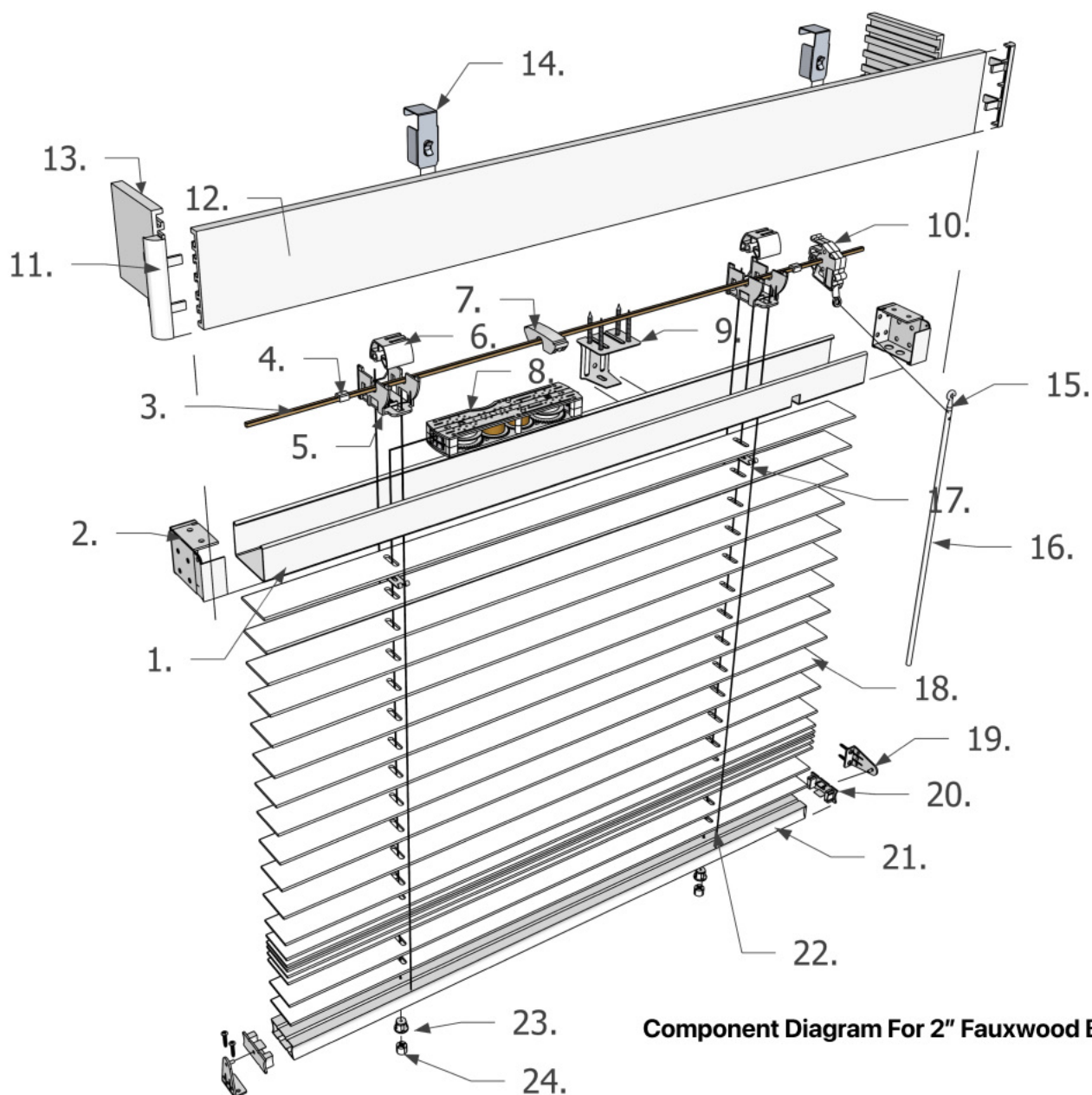

COMPONENTS FOR REFERENCE:

- | | | |
|-------------------------|------------------------------|-----------------------------|
| 1. Headrail | 9. Center support | 17. Slat clip |
| 2. Box bracket | 10. Wand tilter | 18. Slat |
| 3. Tilt rod | 11. Valance return connector | 19. Hold down bracket |
| 4. Tilt rod stopper | 12. Valance | 20. Bottom rail end-cap |
| 5. Tape drum support | 13. Valance return | 21. Bottom rail |
| 6. Tape drum | 14. Valance clip | 22. Ladder string |
| 7. Cordless module lock | 15. Wand connector | 23. Bottom rail button |
| 8. Cordless module | 16. Wand | 24. Bottom rail button plug |

COMPONENTS REFERENCE

1. **Headrail:** Made of U-shaped extruded PVC, 2-3/8" deep x 1-5/8" high x 1/16" thick, co-extruded for strength with a smooth surface.
2. **Box Brackets:** Universal hinged front cover, made of phosphate-treated steel with urethane primer and baked enamel finish to match headrail.
3. **Tilter rod:** The Tilter rod shall be electro-zinc plated square steel with 4mmx4mm dimension.
5. **Tape drum Support:** Made of high strength thermoplastic. It provides cradle for tape drum inside the headrail.
6. **Tape drum:** The Tape drum shall be made of high strength thermoplastic. It secures the ladder strings firmly inside the headrail.
8. **Cordless Modules:** PVC body with pre-wound white lift cord and internal steel spring for smooth tension and lift.
9. **Center Support:** The center support is made of solid steel, zinc-plated.
10. **Wand tilter:** The Wand tilter should be a snap-in component incorporating a worm and pulley of low friction thermoplastic and nylon gear.
12. **Valance:** Extruded foam PVC, standard flat design at 3.25" high x 3/8" thick. Optional 3.25" crown valance available.
14. **Valance clip:** Made of cold rolled steel, heat treated.
16. **Tilt Wand:** Made of 100% PVC, color-matched with slats, available in various lengths upon request.
17. **Slat clips:** The Slat Clips shall be 2" clear enclosed slat made of PP.
18. **Slats:** Rigid, UV-stabilized flat PVC, 2" wide x 0.1" thick, with straight-cut edges.
20. **Bottom rail End-caps:** Made of ABS, flush-mounted, and color-matched with slats, headrail, and bottom rail.
21. **Bottom rail(NO.21):** Co-extruded foam PVC, 2" deep x 7/8" high x 1/16" thick, hollow core for added weight, with dual internal supports to prevent bending on wide widths.
22. **Ladder string:** The Ladder string shall be made of 54x46 braided 100% Polyester, incorporating two extra strength rungs per ladder for slat support. Standard ladder spacing shall be 44mm.

CARE INSTRUCTIONS & PRODUCT STANDARDS

CARING INSTRUCTION

- Blinds California fauxwood blind is designed to last a long time for residential and commercial applications.
- Regular cleaning will help the visual quality.
- Use an ostrich feather duster regularly to remove light dust. Or use slightly dampened cloth to wipe slats for a more thorough clean.
- For excessive sunlight and heat exposure, picking a lighter color over darker color will help to ease the potential slat warp.
- Our blinds are designed for indoor use only.

SAFETY STANDARD

2" cordless fauxwood blind meets ANSI+WCMA A100.1-2022 standard

FIRE RATING

Products meet ASTM International Fire and Flammability standard

UV TESTING RATE

500 hours

HEAT RESISTANCE

140 degree Fahrenheit

COUNTRY OF ORIGIN

Made in China

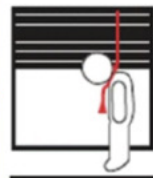

Window Blind Cord Strangulation Risk

A retractable window blind cord that fails to fully retract poses a strangulation risk to children. Remove from use and repair or replace if cord fails to fully retract

PRODUCT OPTIONS, DIMENSIONS & INSTALLATION GUIDE

FAUXWOOD SLAT OPTIONS AND COLOR

Color	2"	Rails and Box Bracket	Wand
	Finish		
White	 Smooth	White	White

VALANCE OPTIONS

Color	3.25" Flat Standard	Mount Type	Valance Length	Return Length
White		Inside mount	Measure width+1"	3/4"
		Outside mount	Measure width+1"	2 3/4"

SIZE LIMITATION

Size Limitation	Inches
Minimum Width	18"
Minimum Height	24"
Maximum Width	96"
Maximum Height	84"

STACKING HEIGHT

Blind Drop	2" Blind Stacking Height
36"	5.25"
48"	6"
60"	6.75"
72"	7.5"
84"	8.25"

* All stacking sizes are approximate

STANDARD WAND LENGTH

Blind Width	Wand Length
$W \leq 30"$	20"L
$W > 30"$	24"L

* Left tilt only

MOUNTING SPACE(2" BLIND)

Mounting Space	Depth
Minimum mounting space	1.5"
Minimum flush mounting space	2.5"

MOUNTING HARDWARE QUANTITY

FAUXWOOD SLAT OPTIONS AND COLOR

Blind width	Box Brackets	Center Support	Hold down Brackets	Pan Head Screw for Hold Down	Valance Clips	Ladder Count	Plastic Plug	Lift Cord Count	Hex Head Screws
24	1 pair	0	1 pair	4	2	2	8	2	8
30	1 pair	0	1 pair	4	2	3	8	2	8
36	1 pair	0	1 pair	4	2	3	8	2	8
42	1 pair	1	1 pair	4	3	4	11	2/4	11
48	1 pair	1	1 pair	4	3	4	11	4	11
54	1 pair	2	1 pair	4	4	5	14	4	14
60	1 pair	2	1 pair	4	4	5	14	4	14
66	1 pair	2	1 pair	4	4	6	14	4	14
72	1 pair	3	1 pair	4	4	6	14	4	14
96	1 pair	3	1 pair	4	4	6	14	4	14

*Product specification is subject to change without notice.

WHOLESALE PRICE CHART

2" FAUXWOOD BLINDS SMOOTH WHITE (MSRP)

Height ↓	Width →	24"	30"	36"	42"	48"	54"	60"	72"	96"
36"		\$185	\$200	\$223	\$257	\$261	\$266	\$313	\$325	N/A
48"		\$194	\$209	\$238	\$266	\$270	\$294	\$332	\$368	\$469
60"		\$211	\$223	\$248	\$280	\$313	\$323	\$380	\$439	\$555
72"		\$238	\$261	\$285	\$308	\$342	\$400	\$441	\$512	N/A
84"		\$257	\$276	\$299	\$323	\$375	\$521	\$592	\$701	N/A

*Tile Cut Fee (Net): \$12/Blind.

*Fauxwood blinds in the width range 72 1/8"–89 7/8" are currently not available.

MEASURING GUIDE FOR INSIDE & OUTSIDE MOUNTS

Measure each window individually as sizes may vary. Measure width first, then height (length) to the nearest 1/8". Measure width from left to right, height from top to bottom using a metal tape measure.

***PLEASE DO NOT USE A CLOTH TAPE!**

INSIDE MOUNT

Inside mount shades are installed inside the window frame.

1. Measure the exact inside width of the window frame from one inside edge to the other. Take three measurements - one near the top, one in the center, and one near the bottom. Record the narrowest measurement.
2. Measure the exact height in three places: left, center and right from top edge of opening to top of sill. Record the longest measurement.
3. Do not take deductions on inside mount measurements. The factory will take an 1/2" allowances for operating clearance.
4. Measure the window diagonally in two places as shown. If the two diagonal measurements are not the same, we suggest an outside mount application for the best shade performance and appearance.

OUTSIDE MOUNT

Outside mount shades are installed outside the window frame, covering an area larger than the window itself.

1. Measure the exact width of the area to be covered. Be certain the measurement overlaps the window opening by at least 1-1/2" on each side to ensure privacy and light control.
2. Measure exact height to be covered, including desired overlap (usually from top edge of molding to bottom edge, or to top of sill). If there is no sill, measure to where the shade is to reach.
3. The factory does not make deductions for an outside mount.

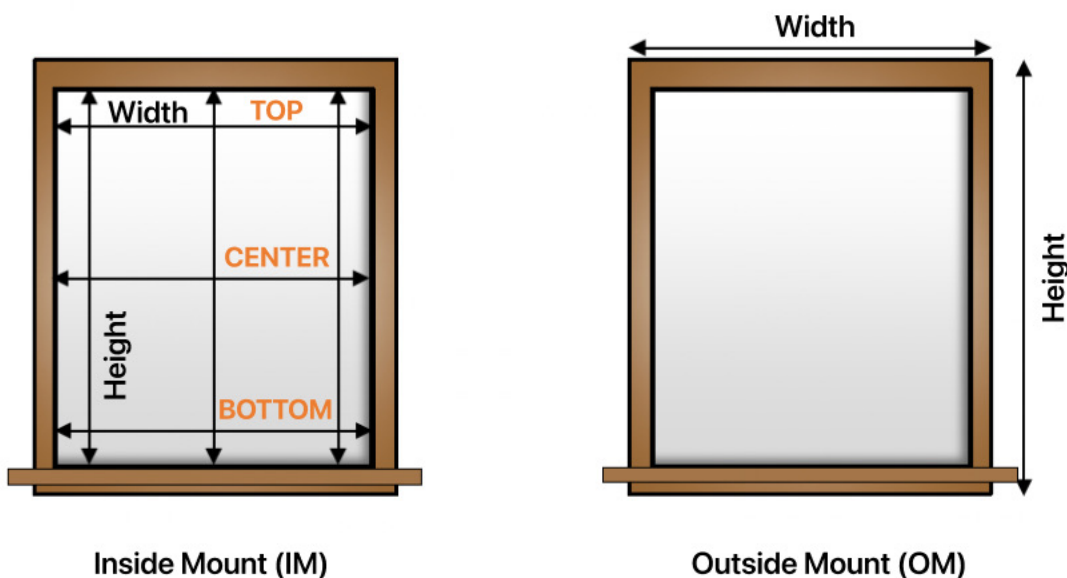

CONTRACT QUOTE OPTIONS & ORDERING TERMS

Blinds California offers contract quote with varieties of options.

WE OFFER

- Quick Ship - ship from local US warehouses.
- Cross Dock - overseas production – 75 days.
- Direct Import pricing on full and partial container quantity.

****Lead times are confirmed based on the order size, special needs, and production schedule.***

****Deposit is required.***

WE MAKE IT EASY TO GET A QUOTE

1. Submit your quote request via email or phone with attention "Sales Quote".

Email address: orders@blindscalifornia.com

Phone call: 909-660-6000

We encourage you to submit quote request via email for better accuracy.

2. Our quote specialist will work with you on special needs such as products, packaging, and pricing during your bidding time.

****The confirmation will be emailed back within 48 hours.***

3. Please review your quote and confirm it via email to give us your approval. The customer service will convert it to an order and process.

TERMS FOR U.S. CONTRACT QUOTE

- Minimum Order Quantity (MOQ) for the contractor quote is 100 units.
- All contract quotes are guaranteed for 90 days.
- When and if necessary - the quote older than 90 days are the subject to a 0.5% price adjustment per month, subject to the material cost increases.
- Deposit is required.

TERMS FOR OVERSEAS PRODUCTION

- Typical overseas production minimum order quantity is 500 pcs per color.
- Product specification can be customized for overseas production.
- Deposit is required.
- Price may vary based on market condition, freight fluctuation and government duty.
- Cross dock and direct import quote is valid for 60 days.